

PENTAX™

Service Parts List

PENTAX *K-7*



Product No.77240

EXPLODED ILLUSTRATION

⊙ : G126	⊠ : G134	⊚ : G151	⊠ : G31
⊙ : L127	⊠ : L115	⊚ : Dia bond 1663	⊠ : Dia bond DA619
⊙ : Three bond 1401C	⊙ : Loctite 401		
⊙ : Super-X 8008 (White)	⊙ : Super-X 8008 (Black)	⊙ : Super-X 8008 (Clear)	
DT : Double stick tape (Size)	BT : Black tape (Size)	NS : No supply	

A

A

B

B

C

C

D

D

E

E

F

F

G

G

H

H

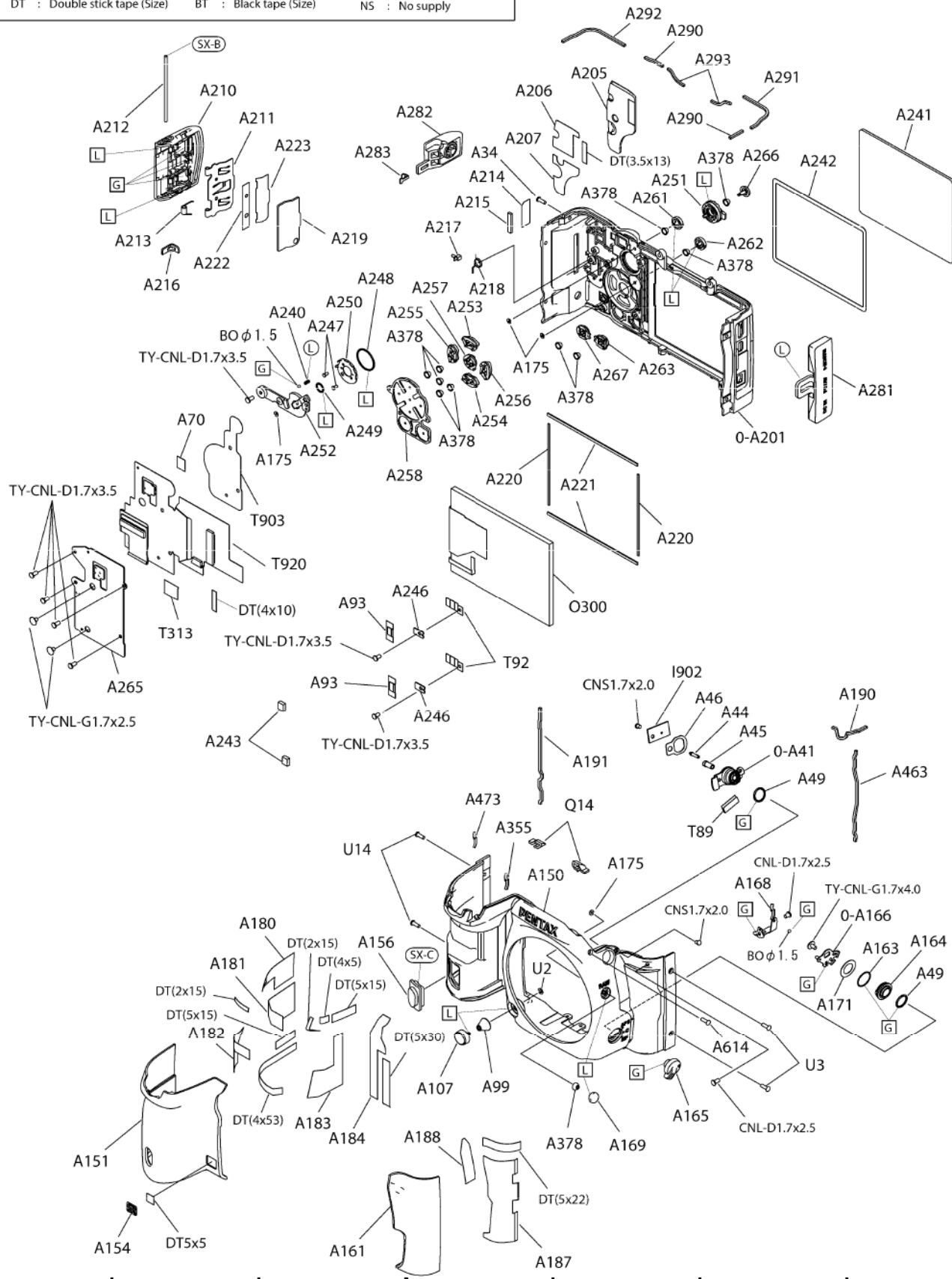

1

2

3

4

5

6

7

EXPLODED ILLUSTRATION

⊙ : G126	⊙ : G134	△ : G151	◇ : G31
⊙ : L127	⊙ : L115	⊙ : Dia bond 1663	⊙ : Dia bond DA619
⊙ : Three bond 1401C	⊙ : Loctite 401		
⊙ : Super-X 8008 (White)	⊙ : Super-X 8008 (Black)	⊙ : Super-X 8008 (Clear)	
DT : Double stick tape (Size)	BT : Black tape (Size)	NS : No supply	

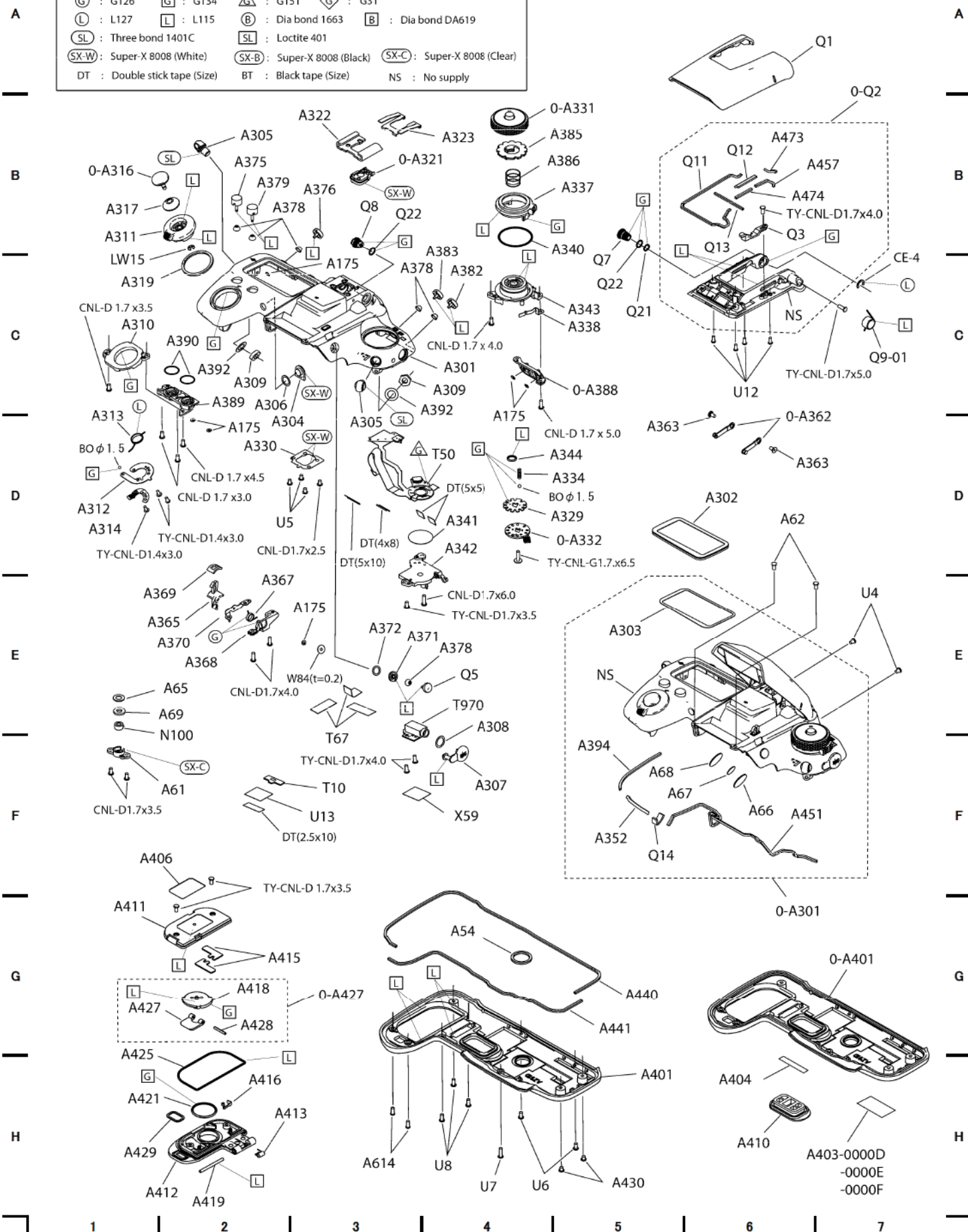

Product No.77240

PENTAX K-7

Fig.2

EXPLODED ILLUSTRATION

⊙ : G126	⊠ : G134	⊠ : G151	⊠ : G31
⊙ : L127	⊠ : L115	⊠ : Dia bond 1663	⊠ : Dia bond DA619
⊙ : Three bond 1401C	⊠ : Loctite 401	⊠ : Super-X 8008 (White)	⊠ : Super-X 8008 (Black)
⊠ : Super-X 8008 (Clear)	DT : Double stick tape (Size)	BT : Black tape (Size)	NS : No supply

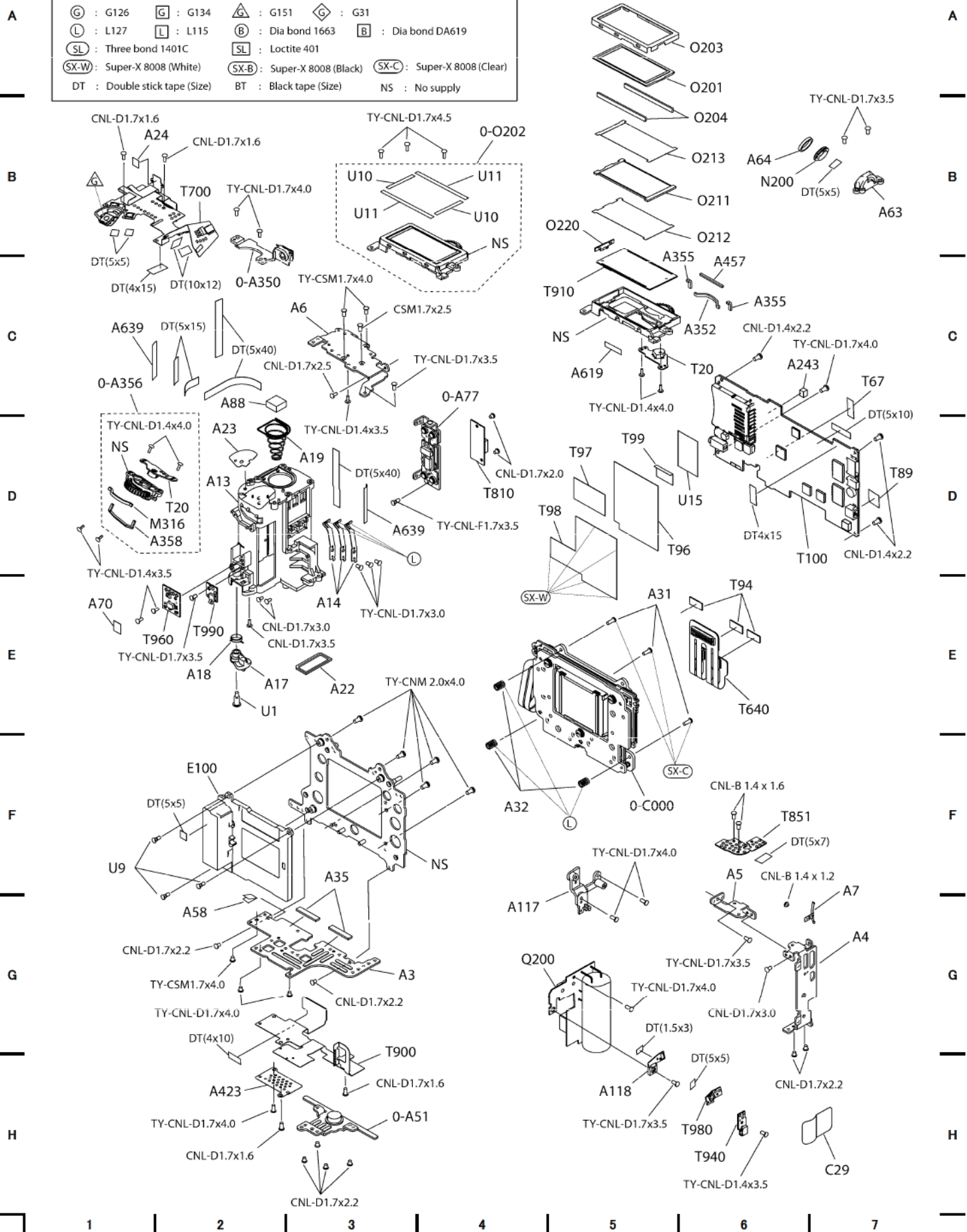

EXPLODED ILLUSTRATION

⊙ : G126	⊠ : G134	⊠ : G151	⊠ : G31	⊠ : L121
⊙ : L127	⊠ : L115	⊠ : Dia bond 1663	⊠ : Dia bond DA619	
⊙ : Three bond 1401C	⊙ : Loctite 401			
⊙ : Super-X 8008 (White)	⊙ : Super-X 8008 (Black)	⊙ : Super-X 8008 (Clear)		
DT : Double stick tape (Size)	BT : Black tape (Size)	NS : No supply		

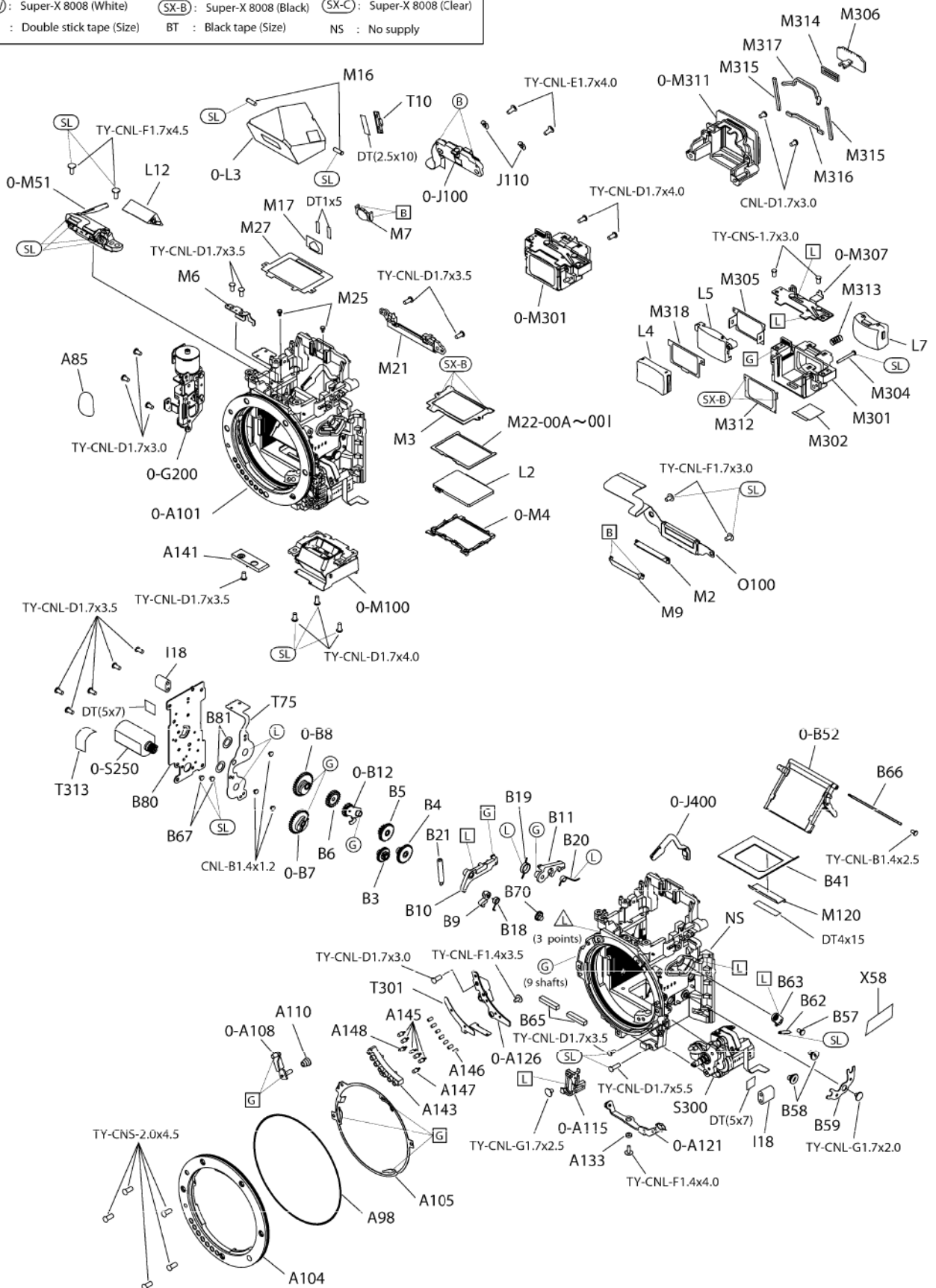

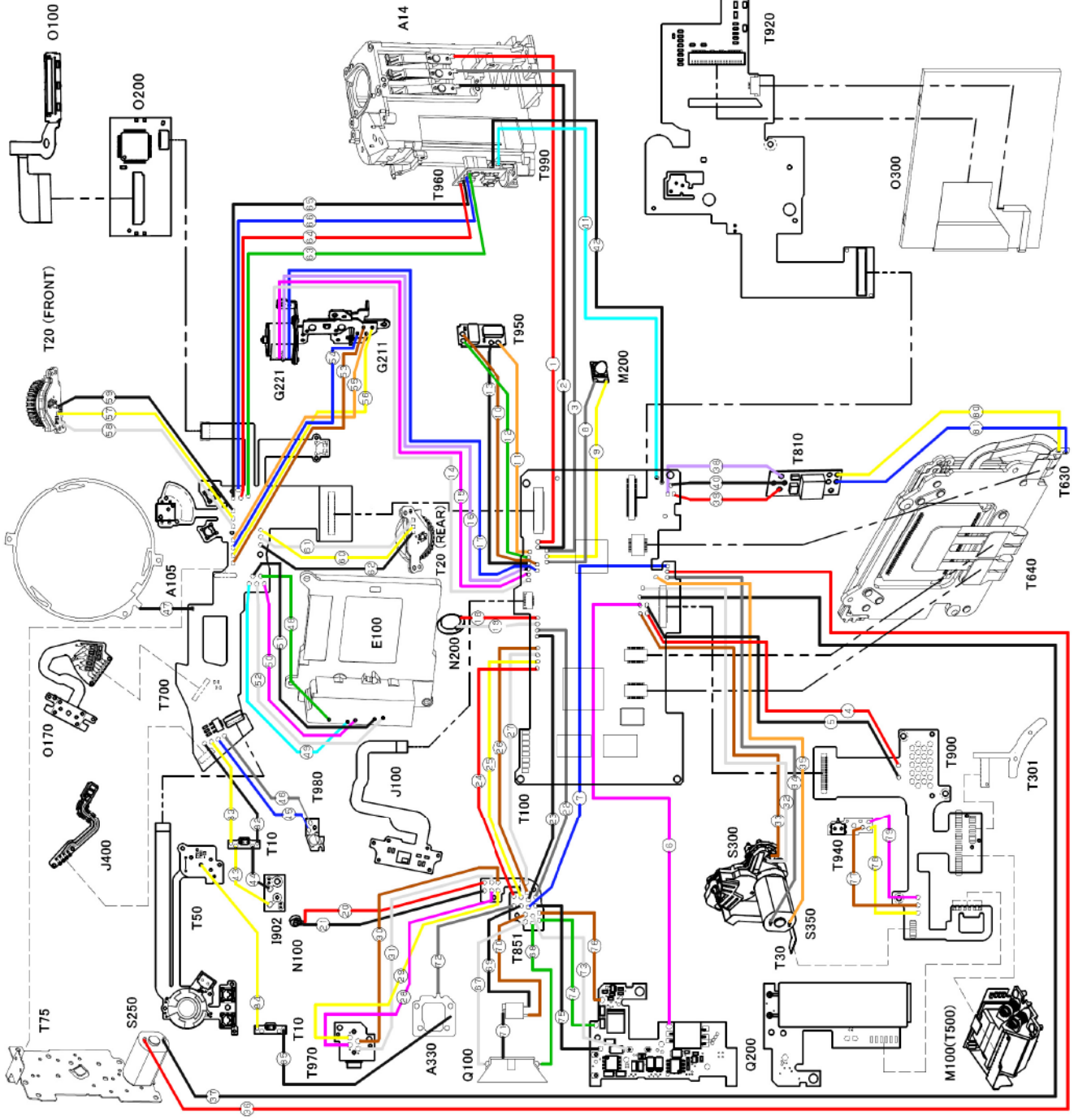

No	Color	Length	from	to
1	RED (赤)	45	A14-T100	Ba111-*
2	BLACK (黒)	50	A14-T100	Ba111-
3	BLACK (黒)	40	A14-T100	Ba111-
4	BLACK (黒)	45	A14-T100	Ba112-(61P)
5	BLACK (黒)	45	A14-T100	Ba112-(61P)
6	PINK (桃)	145	Q200-T100	Q-Vin
7	BLUE (青)	150	T100-T851	P-GND
8	GLAY (灰)	50	M200-T100	AFLED-K
9	YELLOW (黄)	50	M200-T100	AFLED-K (PH.5, W)
10	BROWN (茶)	70	T100-T950	SR3-3V
11	ORANGE (橙)	85	T100-T950	GYRO-X (OUTA)
12	GREEN (緑)	70	T100-T950	GYRO-X (OUTB)
13	BLACK (黒)	80	T100-T950	D-GND
14	WHITE (白)	70	G220/G2000-T100	G200-1 (B)
15	PINK (桃)	75	G220/G2000-T100	G200-2 (B)
16	WHITE (白)	70	G220/G2000-T100	G200-4 (B)
17	BLUE (青)	70	G220/G2000-T100	G200-4 (D)
18	RED (赤)	70	N200-T100	SPKR+
19	WHITE (白)	65	N200-T100	SPKR-
20	RED (赤)	110	N100-T851	MICL+
21	BLACK (黒)	110	N100-T851	MICL-
22	GLAY (灰)	75	T851-T100	MICL+
23	BLACK (黒)	70	T851-T100	MICL-
24	RED (赤)	65	T100-T851	EXT-MIC Det
25	YELLOW (黄)	65	T100-T851	EXT-MIC L
26	BROWN (茶)	70	T100-T851	D-GND
27	WHITE (白)	70	T100-T851	EXT-MIC R
28	YELLOW (黄)	70	T851-T970	EXT-MIC Det
29	BROWN (茶)	70	T851-T970	EXT-MIC L
30	YELLOW (黄)	70	T851-T970	EXT-MIC R
31	WHITE (白)	70	T851-T970	D-GND
32	WHITE (白)	115	S300-T100	D-GND
33	BROWN (茶)	120	S300-T100	VLENS
34	GLAY (灰)	130	S300-T100	S350-B
35	ORANGE (橙)	140	S350-T100	S350-A
36	RED (赤)	60	S250-T100	S250-A
37	BLACK (黒)	70	S250-T100	S250-B
38	TOILET (茶)	85	T810-T100	ADR-PHM
39	RED (赤)	50	T810-T100	ADR-V
40	BLACK (黒)	120	T100-T900	IND
41	SKY BLUE (青)	130	T100-T900	IND
42	BLACK (黒)	130	T100-T900	D-GND
43	YELLOW (黄)	30	Q02-T010	S-F T
44	BLACK (黒)	25	Q02-T010	P-GND
45	BLUE (青)	45	T700-T980	SWRM
46	GLAY (灰)	45	T700-T980	COM2
47	BLACK (黒)	30	A105-T700	D-GND
48	GREEN (緑)	40	E100-T700	ESMG2
49	SKY BLUE (青)	45	E100-T700	ESMG1
50	PINK (桃)	35	E100-T700	T-VIN
51	BLACK (黒)	35	E100-T700	D-GND
52	BROWN (茶)	95	G210/G2000-T100	S-GND
53	BROWN (茶)	95	G210/G2000-T100	G200-HALL-1
54	BLUE (青)	90	G210/G2000-T100	G200-HALL-2
55	ORANGE (橙)	85	G210/G2000-T100	G200-HALL-3
56	YELLOW (黄)	90	G210/G2000-T100	G200-HALL-4
57	YELLOW (黄)	130	T20-T700	SWFDIALA
58	WHITE (白)	130	T20-T700	SWFDIALB
59	BLACK (黒)	120	T20-T700	D-GND
60	YELLOW (黄)	50	T20-T700	SWFDIALA
61	WHITE (白)	50	T20-T700	SWFDIALB
62	BLACK (黒)	50	T20-T700	D-GND
63	GREEN (緑)	35	T100-T960	SELF-LED-K
64	BLACK (黒)	50	T100-T960	P-GND
65	BLUE (青)	50	T100-T960	P-GND
66	WHITE (白)	50	T100-T960	RCN OUT
67	BLUE (青)	165	Q100-T851	Xe-A
68	GREEN (緑)	165	Q100-T851	Xe-C
69	BLACK (黒)	165	Q100-T851	Tct (P-GND)
70	BROWN (茶)	165	Q100-T851	Tc2
71	BLACK (黒)	25	Q104-Q110	Tc0
72	GRAY (灰)	90	A330-T851	P-GND (SHOE)
73	WHITE (白)	45	O200-T851	Xe-A
74	GREEN (緑)	30	O200-T851	Xe-C
75	BLACK (黒)	20	O200-T851	P-GND
76	BROWN (茶)	30	O200-T851	P-GND
77	BROWN (茶)	30	O200-T851	SWAFM0
78	BROWN (茶)	30	O200-T851	SWAFM1
79	YELLOW (黄)	60	T900-T940	SWAFM0
80	PINK (桃)	60	T900-T940	SWAFM1
81	YELLOW (黄)	95	T630-T810	COM2
82	BLUE (青)	95	T630-T810	UP
83	BLACK (黒)	20	T10-T700	P-GND
84	YELLOW (黄)	20	T10-T700	S-F T
85	YELLOW (黄)	35	T10-T050	X
86	BLACK (黒)	20	A330-T010	P-GND

DISTRIBUTING WIRES Fig.5

Product No.77240 PENTAX K-7

LIST OF SERVICE PARTS

Product No.77240

PENTAX K-7

NOTE: 1.The parts with numbers starting " 0 - " are assembled parts.
2.Only available parts are listed below.

* The column Q is a number of parts used.

The column A is an address in the illustrations of parts.(Fig. / Vertical / Horizontal)

No.	Parts No.	Description	Q	Interchangeability	NM No.	A
	A3	Bottom plate	1			3G3
	A4	Left side plate	1			3G7
	A5	Left shoulder plate	1			3F6
	A6	Right shoulder plate	1			3C3
	A7	GND plate	1			3F7
	A13	Battery case	1			3D2
	A14	Battery contact piece	3			3E3
	A17	Battery hook	1			3E2
	A18	Hook spring	1			3E2
	A19	Battery stimulate spring	1			3D3
	A22	Battery cover water proof sheet	1			3E3
	A23	Main SW adhesive tape	1			3D2
	A24	Double stick tape 5x5 (t=0.135)	1			3B1
	A31	C0 adjusting screw	3	77010-A31		3E5
	A32	C0 adjusting spring	3	76830-A32		3F5
	A34	Cover retainer screw E	1	27340-A34		1B4
	A35	Dust collector sheet	2	76830-A35		3F3
	0 - A41	Synchro terminal assy. (A41,A42,77010-A43)	1			1F6
	A44	Synchro lead	1	77010-A44		1E6
	A45	Insulate tube	1	77010-A45		1E6
	A46	Synchro spacer	1			1E6
	A49	O ring (6x0.8)	2			1F6 1G7
	0 - A51	Tripod plate assy. (A51,A50)	1			3H3
	A54	Tripod screw water proof sheet	1	76830-A54		2G4
	A58	PET tape (5x10)	1	76140-A58		3G2
	A61	Microphone holder	1			2F2
	A62	Cover retainer screw B	2	76180-A62		2D6
	A63	Speaker holder	1			3B7

No.	Parts No.	Description	Q	Interchangeability	NM No.	A
	A64	Speaker stimulate member	1	76650-A32		3B6
	A65	Microphone water proof member	1			2E2
	A66	Speaker water proof member	1			2F6
	A67	Speaker sheet	1			2F5
	A68	Speaker water proof member Tape	1			2F5
	A69	Microphone poron	1			2E2
	A70	Remote control cover	2			1D2 3E1 3C4
	0 - A77	G board plate assy. (A77,A20,A76x4,T950,76830-T64,77010-C42x2, 76140-A47x2,5076290-A75x4,W27 t=0.5 x4)	1			
	A85	Heat conduction putty (10x14.5)	1			4C1
	A88	Poron (8x8)	1			3C2
	A93	PVF tape (5x12)	2	77050-A93		1E3
	A98	O ring (55.3x0.75)	1	76830-A98		4H3
	A99	Lock button packing	1	76830-A99		1G4
	0 - A101	Front housing assy. (A101,A104,A115,B3,B4,B5,B6,B7,B8,B9,B10, B11,B12,B13,B14,B15x2,B16,B17,B18,B20, B21,B52,B53,B54,B66,B70,B80,B81x2,J400, S250,S300,T75, 76830-A98,A108,A116,B19,B63,B65x2, 76450-B2,B41,B55,B59,B62,L1,L6,M120, 76180-A109,A111,A112,A126,B67x2, 27830-B58x2,T301,27810-T83,27780-A133, 27660-E189,27640-A121,A122, 27370-A105,A110,A124,A125,A134,A143, A145x5,A146x7,A147,A148,B57, CNL-B1.4x1.2 x3,TY-CNL-B1.4x2.5, TY-CNL-D1.7x3.0,TY-CNL-D1.7x3.5 x6, TY-CNL-D1.7x5.5,TY-CNL-G1.7x2.0, TY-CNL-G1.7x2.5,TY-CNL-F1.4x3.5, TY-CNL-F1.4x4.0,TY-CNS2.0x4.5 x5)	1			4D3
	A104	Mount ring	1			4H3
	A105	Mount spring	1	27230-A105		4H4
	A107	Mount lock button	1			1G4
	0 - A108	Mount lock pin assy. (76830-A108,76180-A109,A111)	1	76830-0-A108		4G3
	A110	Mount lock pin spring	1	26900-A110		4G3
	0 - A115	AM selecting slide plate assy. (A115,A116)	1			4H5
	A117	Q200 base	1			3G4
	A118	RAW button base	1			3H5
	0 - A121	Joint lever assy. (27640-A121,A122,27370-A134)	1	27640-0-A121		4H6

No.	Parts No.	Description	Q	Interchangeability	NM No.	A
	0 - A126	Connector pin plate assy. (76180-A126,A112,27370-A124,A125)	1	76180-0-A126		4G4
	A133	Joint lever collar	1	27550-A133		4H5
	A141	Solder stand	1	76450-A141		4D2
	A143	Exterior tube	1	27230-A143		4G4
	A145	Connector pin	5	27250-A145-01		4G4
	A146	Connector pin spring	7	26900-A146		4G4
	A147	Connector pin C	1	26900-A147		4G4
	A148	Connector pin B	1	27250-A148-01		4G3
	A150	Front cover	1			1F5
	A151	R grip rubber	1			1H1
	A154	SR plate	1	76830-A154		1H2
	A156	Remote control window	1			1G3
	A161	L grip rubber	1			1H3
	A163	O ring (7.8x0.5)	1			1G7
	A164	AF mode lever base	1			1G7
	A165	AF mode changeover lever	1			1H6
	0 - A166	AF mode plate assy. (A166,A167)	1			1F7
	A168	AF mode click plate	1			1F6
	A169	RAW button	1			1H5
	A171	AF lever spacer	1			1G6
	A175	Retainer ring B	10	27370-A175		1C4 1D3 1F5 2C3 2C4 2D2 2E3 1G3
	A180	Grip rubber tape A	1			1G3
	A181	Grip rubber tape B	1			1G2
	A182	Grip rubber tape C	1			1G2
	A183	Grip rubber tape D	1			1H3
	A184	Grip rubber tape E	1			1H3
	A187	Grip rubber tape F	1			1H5
	A188	Grip rubber tape G	1			1H4
	A190	Water proof sheet (1.2x24)	1			1E7
	A191	Water proof sheet (1.2x62.5)	1			1F5

No.	Parts No.	Description	Q	Interchangeability	NM No.	A
	0 - A201	Back cover assy. (A201,A224,A225)	1			1D6
	A205	Rear grip rubber	1			1B5
	A206	Rear grip rubber tape A	1			1B4
	A207	Rear grip rubber tape B	1			1B4
	A210	SD card cover	1			1B2
	A211	SD card cover plate	1			1B3
	A212	SD card cover shaft	1			1B2
	A213	SD card cover spring	1			1C2
	A214	SD card seal	1			1B4
	A215	Damper rubber (2x12)	1			1B4
	A216	SD card cover shaft cover	1			1C2
	A217	SD card cover detector pin	1			1C4
	A218	SD card cover detector pin spring	1			1C4
	A219	SD card cover sealing	1			1C3
	A220	I-LCD cushion A	2			1D4
	A221	I-LCD cushion B	2			1D5 1D5
	A222	SD card cover sealing double stick tape A	1			1C2
	A223	SD card cover sealing double stick tape B	1			1B3
	A240	Lever click spring	1	76830-A256		1C3
	A241	I-LCD window	1			1B7
	A242	I-LCD window retainer tape	1			1B6
	A243	Poron (3x4)	3			1F2 3C6
	A246	I-LCD retainer plate	2			1E4
	A247	Hold plate screw	2			1C3
	A248	O ring (11.2x0.7)	1			1C3
	A249	O ring (4x0.7)	1			1D3
	A250	Focus Point Select Lever Hold Plate	1			1C3
	A251	Focus Point Select Dial	1			1B5
	A252	Focus Point Base Plate	1			1D3
	A253	4 way button top	1			1C4
	A254	4 way button lower	1			1D4
	A255	4 way button left	1			1C4
	A256	4 way button right	1			1D4
	A257	OK button	1			1C4

No.	Parts No.	Description	Q	Interchangeability	NM No.	A
	A258	Button rubber sheet	1			1D4
	A261	Green button	1			1B5
	A262	Live view button	1			1C6
	A263	INFO button	1			1C5
	A265	Button lining board	1			1E2
	A266	AF button	1			1B6
	A267	MENU button	1			1C5
	A281	Connector cover	1			1D7
	A282	Cable SW cover	1			1B4
	A283	Cable SW cover retainer plate	1			1B3
	A290	Water proof sheet (1.2x9)	2			1B5
	A291	Water proof sheet (1.2x33.5)	1			1B6
	A292	Water proof sheet (1.2x43.5)	1			1A5
	A293	Water proof sheet (1.0x16.5)	2			1B6
	0 - A301	Top cover assy. (A301,A61,A65,A66,A67,A68,A69,A303,A304, A305x2,A306,A307,A308,A309x2,A310,A329, A330,A331,A332,A333,A334,A336,A337,A338, A340,A341,A342,A343,A344,A352,A362x2,A363x2, A365,A367,A368,A369,A370,A371,A372,A375, A376,A379,A382,A383,A384,A385,A386,A387, A388,A389,A390x2,A391x2,A392x2,A394, N100,Q1,Q2,Q3,Q5,Q7,Q8,Q9,Q11,Q12,Q13, Q100,T10,T51,T970,79183-Y39, 77170-A310x4,A324,A325x3, 77050-A451,A457,Q14, 76830-A311,A314,A316,A317,A319-01,A361x2, A378x6,A473,A474,Q4,Q20,Q21,Q22x2,Q23,Q24, 76450-A312,A313,76140-A61,27830-A348x3, 27660-X62,27640-A321,A322-01,27490-A52x2, 27431-A226,27430-X59,27370-A175x6,T67x3,T93, 27355-A304,27159-A42, CNL-D1.7x2.5,CNL-D1.7x3.0 x2,CNL-D1.7x3.5 x3, CNL-D1.7x4.0 x3,CNL-D1.7x4.5,CNL-D1.7x5.0, CNL-D1.7x6.0,TY-CNL-D1.4x3.0 x3, TY-CNL-D1.7x3.5,TY-CNL-D1.7x4.0 x3, TY-CNL-G1.7x6.5,BO φ 1.5 x2,CE-4,W84 t=0.2)	1			2G6
	A301	Top cover	1			2C4
	A302	LCD window	1			2D6
	A303	LCD window double stick tape	1			2E5
	A304	Supporting light window	1			2D2
	A305	Strap ring	2			2B2 2D3
	A306	Supporting light window tape	1			2C2
	A307	Microphone jack cover	1			2F4
	A308	Microphone jack mask	1			2E4

No.	Parts No.	Description	Q	Interchangeability	NM No.	A
	A309	Strap ring nut	2			2C2 2C4
	A310	Main SW plate	1			2C1
	A311	Main SW lever	1	76830-A311		2B1
	A312	Main SW click spring	1	76450-A312		2D1
	A313	Main SW lever spring	1	76450-A313		2D1
	A314	Main SW brush	1	76830-A314		2D1
	0 - A316	Release button assy. (76830-A316,79183-Y39)	1	77010-0-A316		2B1
	A317	Release button rubber	1	76830-A317		2B1
	A319	Main SW lever water proof sheet	1	76830-A319		2B1
	0 - A321	Hot shoe base assy. (27640-A321,77170-A324,A325x3)	1	77170-0-A321		2B3
	A322	Hot shoe (B)	1	27640-A322		2B3
	A323	Hot shoe spring (B)	1	27350-A304		2B4
	A329	MD click plate	1			2D4
	A330	Hot shoe ground plate	1			2D2
	0 - A331	Mode dial assy. (A331,A336,A384,A387)	1			2B4
	0 - A332	Support plate assy. (A332,A333)	1			2D5
	A334	Mode dial spring	1			2D5
	A337	Photometry switch lever	1			2B5
	A338	Lever click spring	1			2C5
	A340	O ring (17.9x0.9)	1			2B4
	A341	Round shape double-sided tape	1			2D4
	A342	Mode dial base plate	1			2D4
	A343	Mode dial shaft	1			2C5
	A344	O ring (3.8x0.9)	1			2D4
	0 - A350	Main switch base plate assy. (A350,M200)	1			3C2
	A352	Dial water proof sheet B	2			2F5
	A355	Dial water proof sheet D	3			1F4 3B5 3C6
	0 - A356	F dial base plate assy. (A356,A345,A346,A347,A348,A351,A358,M316, T20,76830-A354,76700-C6,27440-A247, TY-CNL-D1.4x4.0 x2)	1			3C1
	A358	Dial water proof sheet E	1			3D1

No.	Parts No.	Description	Q	Interchangeability	NM No.	A
	0 - A362	Arm assy. (A362,A361)	2			2D6
	A363	Arm Retainer	2			2D5 2D6
	A365	Flash hook lever	1			2E1
	A367	Flash hook spring	1			2E2
	A368	Flash hook plate	1			2E2
	A369	F water proof sheet	1			2E1
	A370	Flash hook lever retainer plate	1			2E1
	A371	PU-button guide	1			2E3
	A372	PU-button guide tape	1			2E3
	A375	ISO button	1			2B2
	A376	AE-L button	1			2B3 3C6
	A378	Top cover button rubber	17	76830-A378		1B5 1B6 1C4 1C6 1D4 1D5 1H5 2B2 2C3 2E4 2B2
	A379	Xv button	1			2B2
	A382	Replay button	1			2C4
	A383	Delete button	1			2B4
	A385	Mode dial lock plate	1			2B4
	A386	Mode dial lock spring	1			2B4
	0 - A388	Wing side button base assy. (A388,A391x2)	1			2C5
	A389	Grip side button base	1			2C2
	A390	O ring (7.5x0.5)	2			2C2
	A392	Strap ring washer	2			2C2 2C4
	A394	Water proof sheet (1.2x43)	1			2F5
	0 - A401	Bottom cover assy. (A401,A440,A441,76830-A54)	1			2G7
	A401	Bottom cover	1			2H5
	A403 - 0000D	Certification seal d (ASSEMBLED IN PHILIPPINES)	1			2H6
	- 0000E	Certification seal e (Z113)	1			
	- 0000F	Certification seal f (MADE IN PHILIPPINES)	1			
	A404	Serial number plate	1	27251-A404		2H6
	A406	Battery polarity seal	1			2F1
	A410	Connector cap	1			2H6

No.	Parts No.	Description	Q	Interchangeability	NM No.	A
	A411	Battery cover plate	1			2G1
	A412	Battery cover	1			2H1
	A413	Battery cover spring	1	76830-A413		2H2
	A415	Battery cover lock claw	2	77010-A415		2G2
	A416	Battery cover click spring	1	27370-A416		2H2
	A418	Battery cover handle plate	1	77010-A418		2G2
	A419	Battery cover shaft	1			2H2
	A421	O ring (12.5x1.0)	1	76830-A421		2H1
	A423	BG connector mask	1			3H2
	A425	O ring (29.3x0.9)	1			2G1
	0 - A427	Battery cover handle assy. (77010-A427,A428,76830-A418,)	1	77010-0-A427		2G3
	A427	Battery cover handle	1	77010-A427		2G1
	A428	Spring pin	1	76830-A428		2G2
	A429	Battery cover sealing sheet A	1			2H1
	A430	Cover retainer screw M1.7x2.2	2			2H5
	A440	Water proof sheet (1.2x220)	1			2G5
	A441	Water proof sheet (1.2x145)	1			2G5
	A451	Water proof sheet (1.2x170)	1	77050-A451		2F7
	A457	Water proof sheet (1.2x18)	2	77050-A457		2B6 3C6
	A463	Water proof sheet (1.2x60)	1	77050-A463		1F7
	A473	Water proof sheet (1.2x9)	2	76830-A473		1F4 2B6
	A474	Water proof sheet (1.2x13)	1	76830-A474		2B6
	A614	Hinge case screw	3	76290-A614		1G6 2H3
	A619	PVF tape 3x13 (0.08)	1	27480-A619		3C5
	A639	PVF tape (5x25)	2	27480-A639		3C1 3D3
	B3	Mirror reduction gear A	1			4F3
	B4	Mirror reduction gear B	1			4F4
	B5	Mirror reduction gear C	1			4F4
	B6	Idle gear	1			4F3
	0 - B7	2nd charge cam gear assy. (B7,B15)	1			4F3
	0 - B8	1st mirror drive cam gear (B8,B15)	1			4E3
	B9	Lever	1			4F4

No.	Parts No.	Description	Q	Interchangeability	NM No.	A
	B10	Shutter charge lever	1			4F4
	B11	Mirror drive lever	1			4F5
	0 - B12	Gear arm assy. (B12,B13,B14,B16,B17-00A)	1			4F3
	B18	Restitution spring	1			4F4
	B19	Mirror drive spring	1	76830-B19		4F4
	B20	1st mirror restitution spring	1			4F5
	B21	Charge lever restitution spring	1			4F4
	B41	Shading plate	1	76450-B41		4F7
	0 - B52	Mirror seat assy. (B52,B53,B54,76450-B55,L1,L6)	1			4E6
	B57	2nd actuating lever shaft	1	27230-B57		4G7
	B58	Mirror seat receptacle	2	27830-B58		4G6
	B59	Seat receptacle retainer plate	1	76450-B59		4H7
	B62	2nd mirror actuating spring	1	76450-B62		4G6
	B63	2nd mirror actuating lever	1	76830-B63		4G6
	B65	Mirror shock absorber	2	76830-B65		4G5
	B66	Mirror hinge shaft	1			4F7
	B67	Mirror motor retainer screw	2	76180-B67		4F2
	B70	Mirror seat receptacle B	1			4F4
	B80	Cover plate	1			4F2
	B81	Cover plate double stick tape	2			4E2
	C29	Coile retainer tape	1			3H7
	0 - C000	SR block assy. (C1,C3x3,C4x3,C5x3,C21,C31,C32,C33,C34,C35, C41,L201,L202,T71,T630,T650,T661,77050-C2x5, C13x4,C25x4,C29x4,C50,77010-C42x2,C46,T606x3, 76700-C6x3,C7x8,C8x4,C9x6,C10x4,C24x4, C27,C43x3,76140-A47,27431-A226, CNL-D1.7x2.0 x6,CNL-D1.4x2.0 x4,CNL-D1.7x1.4 x2)	1			3F5
	E100	Shutter block	1			3F2
	0 - G200	Diaphragm control block (G200,G208x2,G210,G220,G231,G232,G235, G236,76700-C23x2,CNL-B1.4x2.5 x2)	1			4D2
	I18	Rib core	2	27550-S364		4E2 4H6
	I902	Sync circuit board	1			1E5
	0 - J100	Photo sensor block assy. (J100,27370-T313,27480-C127)	1			4B4
	J110	Friction washer	2			4B4

No.	Parts No.	Description	Q	Interchangeability	NM No.	A
	0 - J400	J400 circuit block assy. (J400,27660-E189)	1			4F6
	L2	Fresnel lens (MF-60)	1			4D4
	0 - L3	Pentaprism assy. (L3,27640-M8x2,27370-T52x2,76450-M10)	1			4B2
	L4	Eyepiece front lens	1			4C5
	L5	Eyepiece intermediate lens	1	76830-L5		4C6
	L7	Eyepiece rear lens	1	76830-L7		4C7
	L12	SI prism	1	76450-L12		4B2
	M2	Display prism	1	76450-M2		4E6
	M3	Finder mask	1			4D4
	0 - M4	Fresnel lens retainer frame assy. (M4,76830-M11,M12,M13x2)	1			4D4
	M6	Retainer holder	1			4C2
	M7	Condenser lens	1			4C4
	M9	Display prism light seal plate	1	76450-M9		4E5
	M16	Pentaprism retainer screw	2	25300-M26		4B3
	M17	Condenser mask	1			4B3
	M21	L2 retainer frame holder	1			4C4
	M22 - 00A	Focus adjusting washer a (0.1)	1			4D4
	- 00B	Focus adjusting washer b (0.15)	1			
	- 00C	Focus adjusting washer c (0.2)	1			
	- 00D	Focus adjusting washer d (0.2.5)	1			
	- 00E	Focus adjusting washer e (0.3)	1			
	- 00F	Focus adjusting washer f (0.3.5)	1			
	- 00G	Focus adjusting washer g (0.4)	1			
	- 00H	Focus adjusting washer h (0.45)	1			
	- 00I	Focus adjusting washer i (0.5)	1			
	M25	Positioning pin	2			4C3
	M27	Finder LCD mask	1			4C3
	0 - M51	SI holder assy. (M51,M52,M53,M56,M57x4,M58,O170, 76650-A79x2,76450-L10,L11,76140-A85, 76130-A21,76030-A63x2,27510-A43,27480C127x2)	1			4B1
	0 - M100	AF block assy. (M100,76180-M125)	1			4E3
	M120	AF shading plate	1	76450-M120		4F7
	0 - M301	Eyepiece frame assy. (M301,L4,M304,M307,M308,77010-M309x2, M312,M313,M318,76830-L5,L7,M305,76700-M302, TY-CNS-1.7x3.0 x2)	1			4C5
	M301	Eyepiece frame	1			4D7
	M302	PVF tape (10x13.5)	1	76700-M302		4D7

No.	Parts No.	Description	Q	Interchangeability	NM No.	A
	M304	Intermediate lens guide shaft	1			4C7
	M305	Light seal frame A	1	76570-M305		4C6
	M306	Diopter adjusting lever	1			4A7
	0 - M307	Guide plate assy. (M307,M308,77010-M309x2)	1			4C7
	0 - M311	Eyepiece frame cover assy. (M311,76830-M316,M317,77010-L8)	1			4B6
	M312	Light seal frame B	1			4D6
	M313	Intermediate lens spring	1			4C7
	M314	Adjusting lever water proof sheet	1			4A6
	M315	Water proof sheet (1.5x20)	2			4B6 4B7
	M316	Water proof sheet (1.5x31)	2			3D1 4B7
	M317	Water proof sheet (1.5x34)	1	76830-A463		4B6
	M318	Light seal frame C	1			4C5
	N100	Microphone	1			2E2
	N200	Speaker	1	76650-N200		3B6
	O100	Finder LCD block assy.	1			4E6
	O201	LCD panel	1			3A6
	0 - O202	LCD flame assy. (O202,A345,A346,A347A348,A351,A352,A355x2, O201,O203,O211,O212,O213,O220,T20,T910, 76830-A354,A390x2,A391x2,O204x2,77050-A457, 76700-C6,27480-A619,27440-A247, TY-CNL-D1.4x4.0 x2)	1			3B4
	O203	LCD retainer	1			3A6
	O204	Conductive gum	2	76830-O204		3B6
	O211	Light guide	1			3B6
	O212	Reflection sheet	1			3B6
	O213	Diffusion sheet	1			3B6
	O220	LED board circuit	1			3B5
	O300	Image LCD panel	1			1E5
	Q1	F cover	1			2A6
	0 - Q2	F case assy. (Q2,Q3,Q11,Q12,Q13,Q100,77050-A457, 76830-A473,A474,Q4,Q20,Q23,Q24,27159-A42 TY-CNL-D1.7x4.0)	1			2A7
	Q3	Adjusting plate	1			2B6
	Q5	Flash pop-up button	1			2E4
	Q7	Flash frame shaft A	1			2C5

No.	Parts No.	Description	Q	Interchangeability	NM No.	A
	Q8	Flash frame shaft B	1			2B3
	Q9 01	Pop-up spring	1			2C7
	Q11	Water proof sheet (1x109)	1			2B5
	Q12	Water proof sheet (3.5x15)	1			2B6
	Q13	Water proof sheet (1x23)	1			2B6
	Q14	Water proof sheet (3.2x12)	3	77050-Q14		1F5 2F5
	Q21	O ring (3.14x0.63)	1	76830-Q21		2C5
	Q22	O ring (3.48x0.64)	2	76830-Q22		2B3 2C5
	Q200	Flash circuit	1			3G4
	0-S250	Mirror motor assy. (S250,76450-B2)	1			4F2
	S300	AF drive block	1			4G6
	T10	Reverse polarity flash measures circuit	2			2F3 4B4
	T20	Tv/Av dial P.C.board block	2			3C6 3D2
	T50	Shoe flexible P.C.board	1			2D4
	T67	Black tape (6x15)	4	27250-T67		2F3 3C7
	T75	B0 FPC	1			4E3
	T89	PI tape (8x10)	2	27370-T89		1F6 3D7
	T92	Copper foil tape	2			1E4
	T94	Poron (5x10)	3			3E6
	T96	Shielding sheet (35x35)	1			3D5
	T97	Shielding sheet (15x25)	1			3D5
	T98	Copper foil tape	1			3D5
	T99	Insulation tape sheet (10x18)	1			3D5
	T100	Main circuit board	1			3D6
	T301	Mount P.C.board	1	27830-T301		4G3
	T313	PVF tape (7x15)	2	27370-T313		1E2 4F1
	T640	T650 flexible substrate circuit	1			3E6
	T700	Upper flex circuit -A block	1			3B2
	T810	ADR board circuit	1			3D4
	T851	Flash microphone substrate board	1			3F6
	T900	Lower flex P.C.board	1			3G3
	T903	Switch sheet	1			1D3
	T910	O200 circuit block	1			3C5
	T920	A200 circuit block	1			1E3

No.	Parts No.	Description	Q	Interchangeability	NM No.	A
	T940	AFMD select circuit	1			3H6
	T960	Wireless remote control board	1			3E1
	T970	S microphone connector board	1			2E4
	T980	RAW switch board circuit	1			3H6
	T990	Reset switch board circuit	1			3E2
	U1	F case axis screw	1	27810-Q7		3E2
	U2	Retainer ring A	1	27030-A358		1G4
	U3	Retainer screw C	2	27340-A33		1G6
	U4	Cover retainer screw F	2	27551-A189		2E7
	U5	Hot shoe retainer screw	3	27830-A348		2D2
	U6	Cover retainer screw F	2	27250-A185		2H4
	U7	Cover retainer screw A	1	77050-A430		2H4
	U8	Cover retainer screw C	3	27640-A184		2H4
	U9	Screw C	3	76450-A70		3F1
	U10	S-LCD cushion A	2	77010-A390		3B3 3B4
	U11	S-LCD cushion B	2	76830-A391		3B3 3B4
	U12	Cover retainer screw A	4	77170-A310		2C6
	U13	PI tape (13x17)	1	76140-A61		2F3
	U14	Cover retainer screw G	2	26902-A256		1F3
	U15	PI tape (13x25)	1	76070-A29		3D6
	X58	PVF tape (3.5x14)	1	27850-X58		4G7
	X59	PVF tape 10x13 (0.08)	1	27430-X59		2F4

		BO ϕ 1.5 (Code No.4700150)	4			1C2 1G6 2D1 2D4 2E2
		W84 (t=0.2) (Code No.2842030)	1			2E2
		CE-4 (Code No.3240000)	1			2C7
		LW15 (Code No.3033000)	1			2C1
		CNL-B1.4x1.2 (Code No.1151121)	4			3F6 4F2
		CNL-B1.4x1.6 (Code No.1151161)	2			3F6
		CNL-D1.4x2.2 (Code No.1171221)	3			3D7
		CNL-D1.7x1.6 (Code No.1172161)	4			3B1 3B2 3H2 3H3

No.	Parts No.	Description	Q	Interchangeability	NM No.	A
		CNL-D1.7x2.0 (Code No.1172201)	2			3D4
		CNL-D1.7x2.2 (Code No.1172221)	8			3G1 3G3 3H3 3H6
		CNL-D1.7x2.5 (Code No.1172251)	4			1F6 1H6 2D2
		CNL-D1.7x3.0 (Code No.1172301)	7			3C2 2D2 3E2 3G6 4B6
		CNL-D1.7x3.5 (Code No.1172351)	4			2C1 2F1 3E2
		CNL-D1.7x4.0 (Code No.1172401)	3			2C4 2E2
		CNL-D1.7x4.5 (Code No.1172451)	1			2D2
		CNL-D1.7x5.0 (Code No.1172501)	1			2D4
		CNL-D1.7x6.0 (Code No.1172601)	1			2E4
		CNS1.7x2.0 (Code No.1082201)	2			1E5 1F5
		CSM1.7x2.5 (Code No.1112251)	1			3C3
		TY-CNL-B1.4x2.5 (Code No.6151251)	1			4F7
		TY-CNL-D1.4x3.0 (Code No.6171301)	3			2D1
		TY-CNL-D1.4x3.5 (Code No.6171351)	4			3D1 3D3 3H6
		TY-CNL-D1.4x4.0 (Code No.6171401)	4			3C5 3D1
		TY-CNL-D1.7x3.0 (Code No.6172301)	7			3E3 4D1 4G3
		TY-CNL-D1.7x3.5 (Code No.6172351)	29			1C2 1D1 1E2 1F3 2E4 2F2 3B2 3B7 3C4 3E1 3G5 3H5 4C2 4C4 4E1 4E2 4G5
		TY-CNL-D1.7x4.0 (Code No.6172401)	17			2B6 2F3 3F5 3G2 3G5 3H2 4B5 4E3
		TY-CNL-D1.7x4.5 (Code No.6172451)	3			3B3

No.	Parts No.	Description	Q	Interchangeability	NM No.	A
		TY-CNL-D1.7x5.0 (Code No.6172501)	1			2C6
		TY-CNL-D1.7x5.5 (Code No.6172551)	1			4G5
		TY-CNL-E1.7x4.0 (Code No.6182401)	2			4B5
		TY-CNL-F1.4x3.5 (Code No.6191351)	1			4G4
		TY-CNL-F1.4x4.0 (Code No.6191401)	1			4H5
		TY-CNL-F1.7x3.0 (Code No.6191301)	2			4D5
		TY-CNL-F1.7x3.5 (Code No.6191351)	1			3D4
		TY-CNL-F1.7x4.5 (Code No.6191451)	2			4B2
		TY-CNL-G1.7x2.0 (Code No.6202201)	1			4H7
		TY-CNL-G1.7x2.5 (Code No.6202251)	3			1E1 4H4
		TY-CNL-G1.7x4.0 (Code No.6202401)	1			1F6
		TY-CNL-G1.7x6.5 (Code No.6202651)	1			2D4
		TY-CNM2.0x4.0 (Code No.6093401)	5			3E3
		TY-CNS1.7x3.0 (Code No.6082301)	2			4C6
		TY-CNS2.0x4.5 (Code No.6083451)	5			4H2
		TY-CSM1.7x4.0 (Code No.6112401)	3			3C3 3G2